

Roto-Plate Assembly Instructions

Swing Arm Clamp Kit



TOOLS REQUIRED:

TORQUE WRENCH
5/32", 5/16", 9/64" ALLEN WRENCH
THREAD LOCTITE

INSTALLATION:

- Using screws (1), assemble side arm (2) to Roto-Plate (3). **NOTE: USE OF LOCTITE IS NOT REQUIRED. SCREW IS PROVIDED WITH LOCKING NYLON PATCH ALREADY ON THREAD.** Torque all three screws (1) to 70 IN-LBS.
- Separate two halves of Clamp by removing two screws (8).
- Test fit location on Swing Arm where clamp will fit without interfering with other parts of motorcycle, such as belt guard or drive pulley.
- Once location has been determined, if needed, utilize optional sleeve (9) to achieve the desired fit between the Swing Arm Tube and the Clamp.
- Fasten Clamp halves with two screws (8). Torque to 26-28 IN-LBS. Use of Loctite is recommended.
- NOTE: OVER TIGHTENING OF SCREWS (3) COULD CAUSE FASTENER FAILURE AND RESULT IN DAMAGE TO ROTO-PLATE. NOTE: CLAMP MAY CAUSE PERMINATE MARKING OR GROOVING WHEN CLAMP IS TIGHTENED OVER SWING ARM.**
- Fasten Roto-Plate to clamp kit by placing with flat washer (4) onto screw (5).
- Insert screw (5), washer (4) assembly through side arm bracket hole of Roto-Plate
- Thread screw (5) into clamp, do not tighten completely yet. **Use of Loctite is recommended.**
- Before completely tightening Roto-Plate into place, confirm desire angle of display (tilt) and proper clearance when rotating from horizontal to vertical orientations.
- Secure Roto-Plate completely once desired position is achieved. Torque to 56-58 FT-LBS.
- To prevent further movement, insert tighten anti-rotation set screw (6) into side arm (2) and torque to 26-28 IN-LBS. **NOTE: USE OF LOCTITE IS NOT REQUIRED. SCREW IS PROVIDED WITH LOCKING NYLON PATCH ALREADY ON THREAD.**
- Route all wiring through hollow pivot shaft of Roto-Plate. Wire lights as follows:
14. FOR ROTO-PLATE MODEL: Black=Ground, Red =Running lights, Blue=Brake light
15. FOR ROTO-PLATE JR MODEL (w/OPTIONAL LED FRAME): Black=Ground, White=Running lights
- Use of a wire wrap or conduit is recommended and should be inserted completely inside center pivot shaft of Roto-Plate. **NOTE: CARE SHOULD BE TAKEN TO PREVENT WIRE WRAP AND WIRING FROM BEING TOO TIGHT AROUND SNAP RING ON INSIDE OF ROTO-PLATE. SNAP RING FAILURE COULD RESULT IN ASSEMBLY FAILURE AND DAMAGE TO ROTO-PLATE.**
- Solder and heat shrink is recommend for all connections to Roto-Plate wires and motorcycle harness.

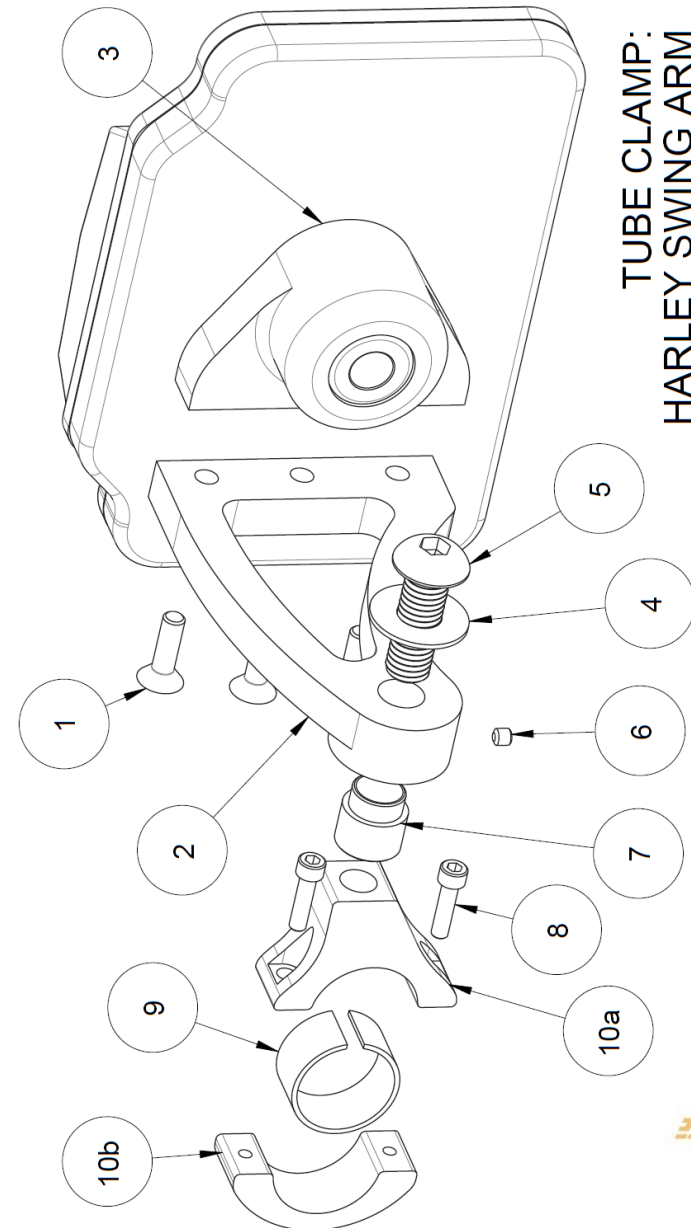

TUBE CLAMP:
HARLEY SWING ARM
UNIVERSAL



REV AD

Top Down Products www.TopDownProducts.com



Top Down Products
www.TopDownProducts.com

